

JET \ Brella

J/B #: PW305A-XGX

Technical Specifications

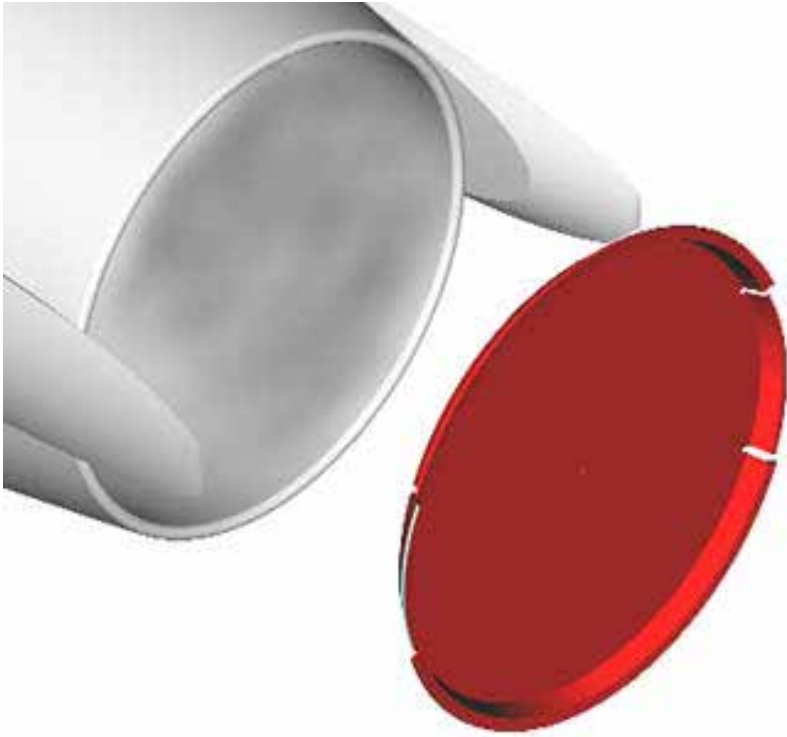

Engine Inlet Cover

Designed to fit:

BOMBARDIER

LEARJET 60

Tech Note:

No drilling is required for the installation and/or operation of any Jet \ Brella inlet, exhaust, or APU cover.

DETAILED SPECIFICATIONS: EXHAUST PLUGS SET

Engine Model - PW305A

Hot Exhaust Plugs - Rigid, thermoformed, FAA FAR 25.853 Approved Material, with vinyl/foam rubber P seal

Diameter - 25"

Depth - 1 3/4"

Weight - 6 lbs.

Units per set - 2 pcs.

Hardware Attachment - None

Options - Restraint webbing, venting, reflective stripes, "REMOVE BEFORE FLIGHT" flags, carry bag, printing/silkscreening

JET \ BRELLA INC. 6849 HAYVENHURST AVENUE, VAN NUYS, CALIFORNIA U.S.A. 91406

TELEPHONE: 1-818-780-1769 FACSIMILE: 1-818-994-9456 WWW.JETBRELLA.COM

SALES EMAIL: SALES@JETBRELLA.COM TECH SUPPORT & SERVICE EMAIL: TECH@JETBRELLA.COM